

Development and production
of laser and sorting systems

IL C3800 Advanced Sorting System



The IL C3800 offers the possibility to integrate a SEMI E63 measurement system. A comprehensive GEM serial communication software is among the numerous options available for IL C3800 system.

The Innolas IL C 3800 is a multi-functional system for sorting, transferring and inspection of 300mm wafers. The detailed configuration and extensive accessories results in the IL C 3800 being an exceptionally powerful and multi-faceted solution. The integrated mini environment has an ionization unit with laminar flow and pressure control.

The IL C 3800 can be equipped with up to seven load/unload stations that can be loaded manually or automatically in accordance with the SEMI E84 specification. The system uses an Innolas edge grip handling system together with a patented Innolas edge grip aligner for automatic orientation of 300mm wafers.



Development and production of laser and sorting systems

Technical Specifications IL C 3800 Series

HANDLING SYSTEM

Wafer sizes:	300mm (12")
Wafer transport:	Robot with linear track and double end effector
Wafer alignment:	Opto mechanical aligner
Wafer handling:	Vacuum or edge grip
Number of stations:	Up to 8 stations (configurable)
Wafer Throughput:	360 wafers/hr (transfer mode) 240 wafers/hr (sort mode)

READING SYSTEM

Fonts:	Dot Matrix (SEMI 5x9, 10x18, 15x23 and 9x17) Barcode (SEMI 412, IBM 412) 2D Code (SEMI T7) Engrave Mode Others on request
Checksum:	SEMI, IBM

STANDARD OPTIONS

- Reading system for wafer front and / or backside
- OHT (Over Head Transport) for cassette loading / unloading
- Barcode hand scanner
- SECS/GEM host software
- Wafer flipping unit for 180°
- Light curtain
- Automatic FOUF loadport
- Automatic open cassette cover for FOUF loadport
- Semiautomatic FOSB loadport
- Smart end effector with R-position wafer correction
- Manual inspection unit
- Automatic inspection units on request

FACILITY REQUIREMENTS

Electrical:	400V AC / 3P / N / PE / 50Hz / 10A 208V AC / 3P / N / PE / 60Hz / 20A 208V AC / 2P / PE / 60Hz / 25A
Communication:	Ethernet RJ45 connector
Vacuum:	-800mbar (23.6Hg) - Festo 8mm OD connection
Compressed air:	8bar (116psi) - Festo 8mm OD connection
PFO:	Process Fluid Outlet - Festo 8mm OD connection
Exhaust:	75m ³ /hr (44.1ft ³ /min) - 50mm ID connection
Weight:	1500kg (3300 lb) depending on options
Mini Environment	Class 4 (ISO EN 14644-1) depends on clean room

CERTIFICATION

CE certificate

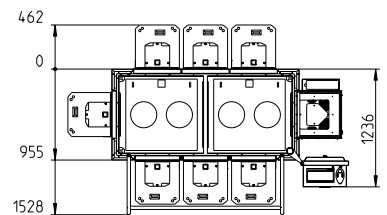
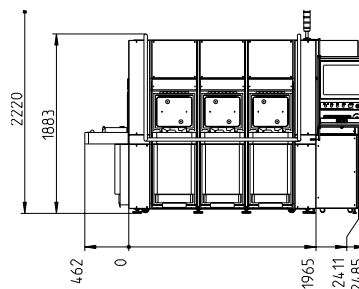

Dimensions in mm