



make your mark

ALLPRINT DN50A Nd:YAG Laser Marker

For crystal-clear marking:

The ALLPRINT DN50A

Nd:YAG laser marker



- **High-speed marking:** up to 30,000 mm/s and 15m/s for on-the-fly applications, thanks to high laser power and fast digital galvanometer technology.
- **Broadest application spectrum** thanks to powerful application software supports and excellent laser beam quality as well as high laser intensities due to adjustable mode aperture.
- **Highly flexible integration** thanks to compact modules and a broad spectrum of beam-turning units. The unique controller and interfacing concept assure an unmatched integration flexibility.

ALLPRINT DN50A **meets the most stringent requirements** regardless of whether throughput, flexibility, user-friendliness, reliability or economy is the prime criterion for your marking application. No matter what has to be marked: **electr(on)ic housings, keyboards, day/night design, identification plates, tools, surgical instruments, fuel-injection nozzles, ball bearings, crankshafts/camshafts, fittings, stamps or injection molds, etc.**

The solid-state system is designed for both **stand-alone systems and easy integration into lines**. It is capable of being completely controlled by computer and is predestined for use in fully automated production. The unique communications concept enables user-friendly and efficient administration of marking jobs with texts, machine-readable codes, graphics or individual data.

Whether as an **engraving, color change, color removal or temper/ black marking** – ALLPRINT DN50A performs convincingly not least on account of its high resolution and brilliant marking quality.

Automotive and metalworking industries:
modular relay
plain metal



Cards and security:
chip card
PVC



Automotive, telecommunications:
day/ night design
plastics



Medical and pharmaceutical:
caps and closures
aluminum



Building services, etc.:
injection molding parts
bulb socket and **extruded parts**
e.g. window frames, etc.
plastics



ALLPRINT DN50A

Nd:YAG Laser Marker

Dimensions

Marking Unit with Marking Head

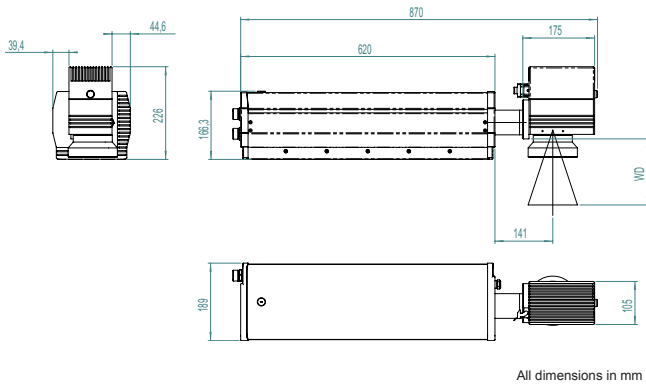

MARKING FEATURES

Marking Speed

- Up to 1,300 characters (30,000 mm/s) per second*

Line Speed

- Up to 15 meters per second*

Marking Field (see graphic)

- Lens options

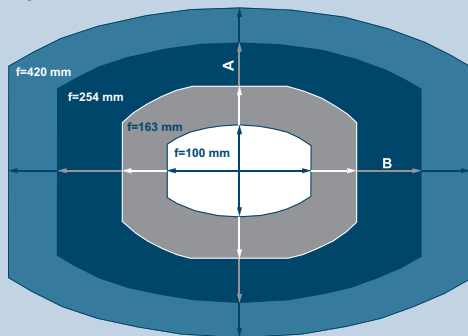

	f = 100 mm	f = 163 mm	f = 254 mm	f = 420 mm
max. A/mm	75.8	142.2	215.5	361.5
max. B/mm	118.7	193.5	301.5	498.5

Marking Formats

- Standard fonts (Windows® TrueType®/ TTF; PostScript®/ PFA, PFB; Open Type®/ OTF)
- Individual and dot- matrix fonts, such as high-speed or OCR
- Machine-readable codes: *ID-MATRIX* (ECC100, 140, 200: 10x10 to 144x144 for square formats, 8x18 to 16x48 for non-square formats; ECC plain [free config. ECC code]; QR-Code); *BAR CODES* (BC25/25i/39/39E/93/128; EAN13/128; UPC_A; RSS14TR/ST/STC; RSS LIM/EXP)
- Graphics/ graphic components, logos, symbols, etc. (DXF, JPG, AI, etc.)
- Linear, circular, angular text marking; rotation, reflection, expansion, compression of marking contents
- Sequence and serial numbering
- Automatic date, layer and time coding, real-time clock
- Online coding of individual data (weight, contents, etc.)

Specifications

LASER

Laser Source

- Diode-pumped Nd:YAG laser, power class 50 W, cw or pulsed (3,000-65,000 Hz), 1.064 µm

Laser Beam Deflection

- Digital high-speed galvanometer scanner

Focusing

- Precision optics: available focal lengths f = 100/163/254/420 mm

OPERATION

- Several options: PC, handheld control unit or software interface
- Real time operation concept
- Storage: RAM 128 MB, Multi Media Card minimum 512 MB

Handheld (optional)

- Graphic remote control via Ethernet for flexible operation
- Preparation of marking jobs, marking data entry
- System configuration
- Status & alarm display
- Excellent legibility of graphic display: fast, intuitive operation

SOFTWARE

Smart Graph (optional)

- Graphics-orientated user interface under Windows® XP/ Vista for the intuitive and fast preparation of complete marking jobs on PCs
- System configuration
- Text/ data/ graphics/ parameter editor
- Configurable in German, English, further languages optional
- Easy access to standard CAD and graphics programs thanks to import functions for the most important file formats
- WYSIWYG
- Various password-protected security levels

Smart Graph Com

- ActiveX software interface for integration into operation software

Communication

- Ethernet (TCP/IP, 100 Mbit LAN), RS232
- Inputs for encoders, bar code readers and product detectors
- 8 bit digital input for digital job selection, start/stop signals, machine/operator interlocks, alarm outputs
- Customer-specific solutions

INTEGRATION

- Direct integration into complex production lines by means of the laser's scripting interface
- Integration via Ethernet and RS232 interface
- Easy integration via flexible umbilical, optional 6/10/15 m

SUPPLY

Electricity/ Cooling

- 100/230 V (autorange), 1 PH, 48-62 Hz, 2 kVA (incl. cooling)
- Internal water/ air heat exchanger

Environment

- Temperature 5 - 40° C (40 - 105° F)
- Humidity 10 - 90 %, non-condensing

Sealing and Safety Standards

- Supply unit: IP22, marking head: IP44, laser head: IP42; LASER CLASS 4

Weight

- Supply unit 131 kg/288 lbs, marking unit 20 kg/40 lbs

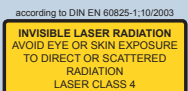

© 2007 ALLTEC GmbH – All rights reserved. Because ALLTEC GmbH makes constant efforts to improve its products, the company reserves the right to change the design and specifications without giving advance notification. Windows and OpenType are registered trademarks of Microsoft Corporation. TrueType is a registered trademark of Apple Computer, Inc. PostScript is a registered trademark of Adobe Systems Inc. DN50A_E 11.07_1 * Printed in Germany | * depends on the application

ALLTEC GmbH

An der Trave 27 - 31 | 23923 Selmsdorf | Germany
 Phone 00 49 .(0)388 23.55-0 | Fax 00 49 .(0)388 23.55 -222
 Email contact@alltec.org | www.alltec.org



make your mark